

Stem-operated valves
3/2- and 5/2-way, M5 (10/32 UNF) – G 1/8,
80 – 320 NI/min (0.081 – 0.325 Cv)

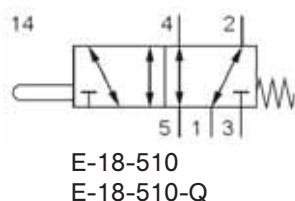

Technical data for series

E

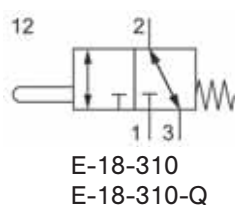
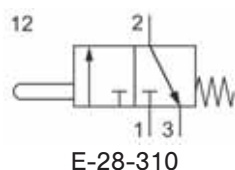
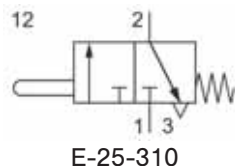

Design and function

To ensure the maximum life of the valve, the actuating mechanism must contact the stem at an angle $\leq 30^\circ$. If this is not possible, a roller lever valve is recommended.

Types E-25-310 and E-28-310: Port 1 must be used as the pressure inlet.

Types E-18-310 and E-18-510: All ports are interchangeable.

Valves E-18-310 and E-18-510 are available for use with vacuum (– 0.95 ... 12 bar / – 14 ... 175 psi). Order number changes to E-18-310-Q and E-18-510-Q.

Order number	E-25-310	E-28-310	E-18-310	E-18-510
Function	3/2-way spring return			5/2-way spring return
Connection	M5 (10/32 UNF)	G 1/8		
Nominal size	2 mm	4 mm		
Flow rate	80 NI/min (0.081 Cv)	210 NI/min (0.213 Cv)	320 NI/min (0.325 Cv)	
Pressure range	0 ... 12 bar (0 ... 175 psi)			
Actuating force at 6 bar	15 N	16 N	27 N	28 N
Temperature range	– 10 °C ... + 70 °C (+ 14 °F ... + 158 °F)			
Materials	Body: Al (anodized), Inner parts: Al, brass, stainless steel, Stem: stainless steel			
	Seals: NBR		Seals: NBR and POM	
Weight	0.034 kg (0.075 lb.)	0.051 kg (0.112 lb.)	0.092 kg (0.203 lb.)	0.115 kg (0.253 lb.)

Stem-operated valves
3/2- and 5/2-way, M5 (10/32 UNF) – G 1/8,
80 – 320 NI/min (0.081 – 0.325 Cv)



Dimensions for series

E

E-25-310

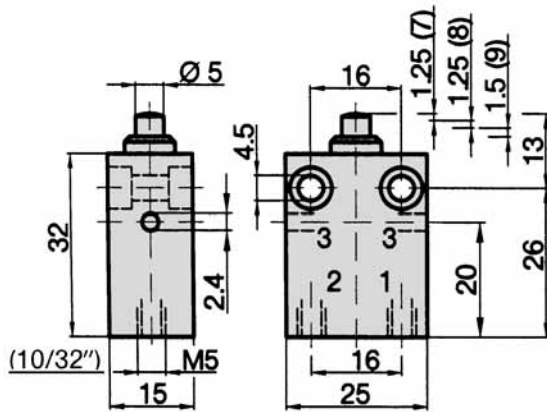

E-28-310

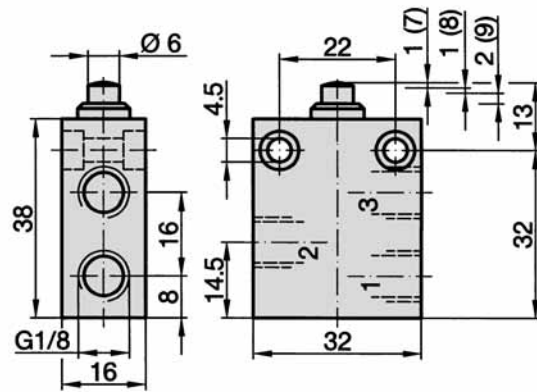

E-18-310, E-18-310-Q

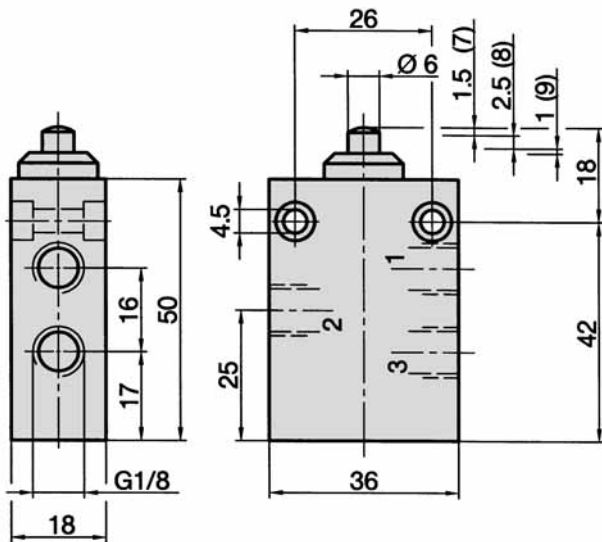

E-18-510, E-18-510-Q

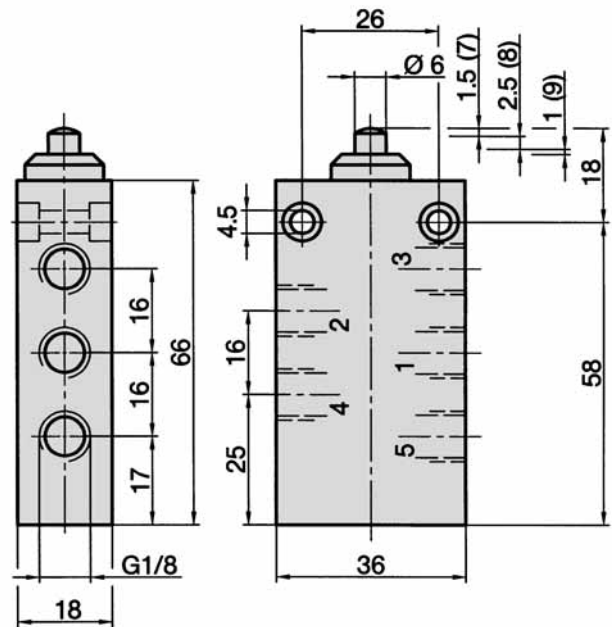

- 1 = pressure inlet
- 2 = outlet
- 3 = exhaust
- 4 = outlet
- 5 = exhaust

- (7) = pre-stroke, valve is not actuated
- (8) = working stroke
- (9) = end of stroke, bottomed